

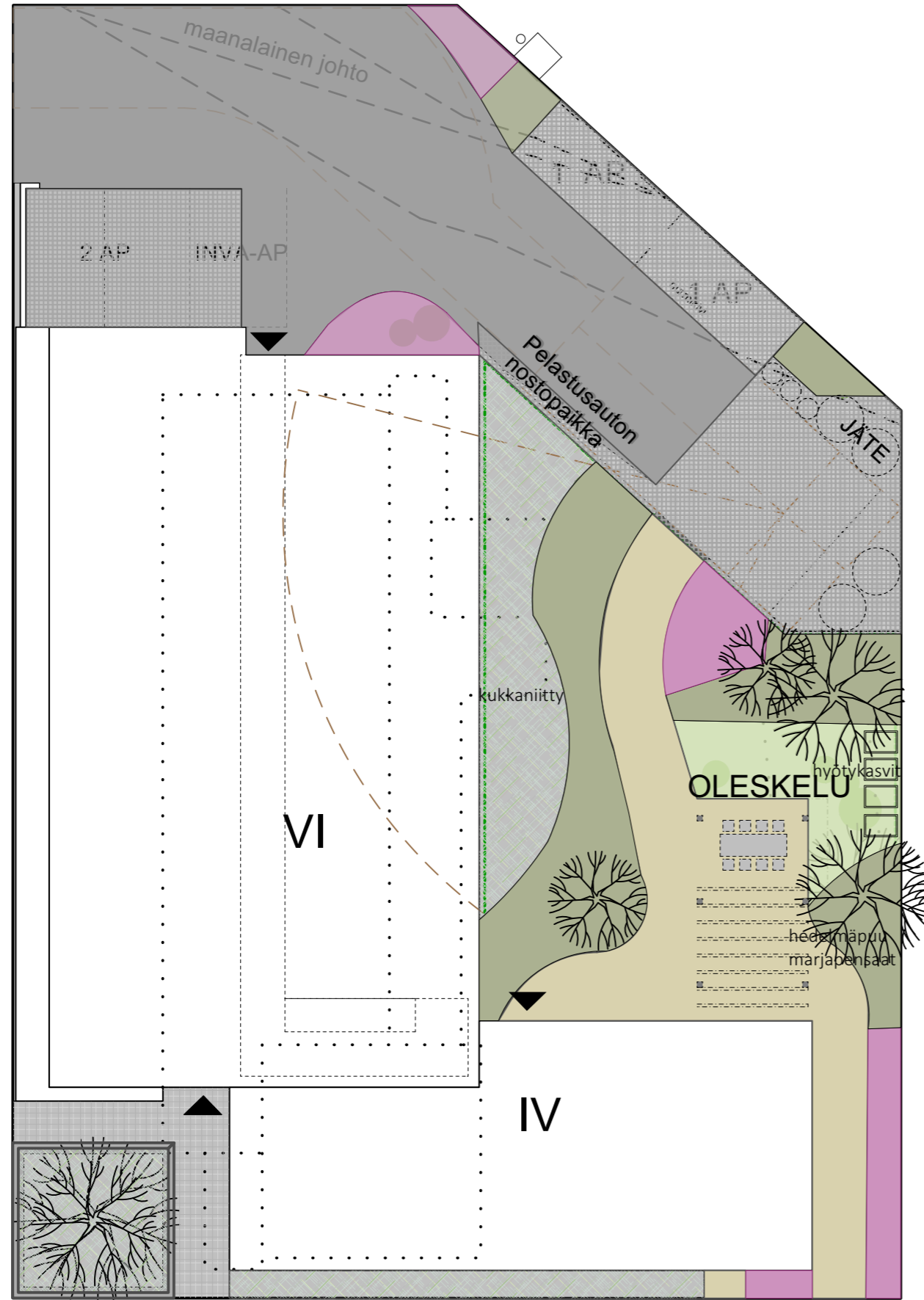

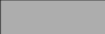







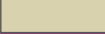

AJO
TONTILLE

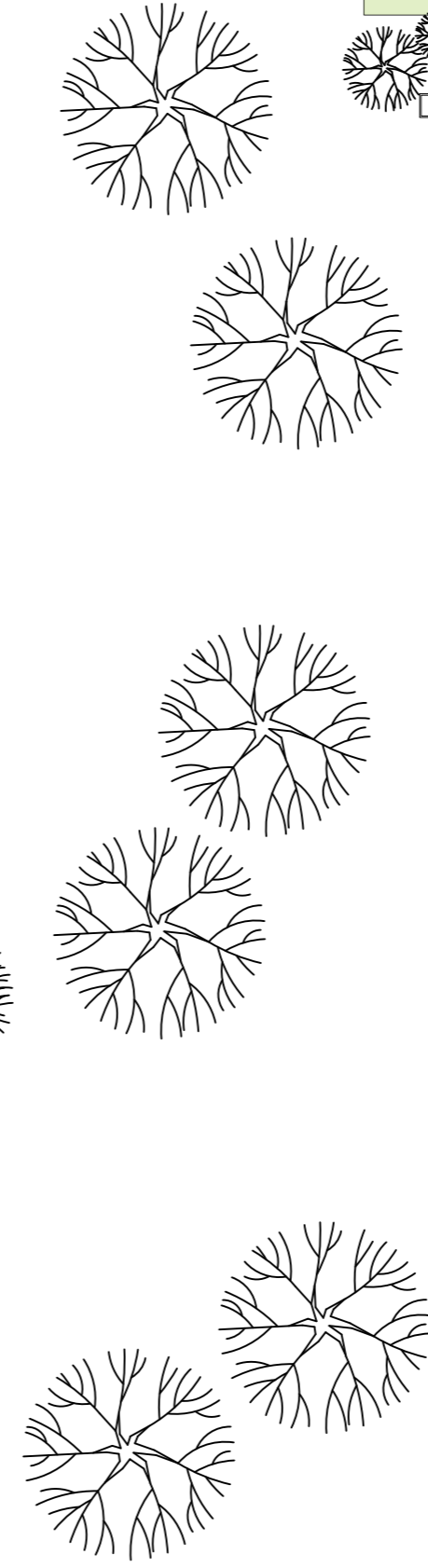

MERKKIEN SELITYKSET

-  ASFALTTI
-  LÄPÄISEVÄ KIVEYS, esim. nurmikivi
-  LAATTA
-  HIEKKA, SORA
-  PERENNA-ALUE
-  MONIMUOTOINEN PENSASISTUTUS, HYÖTYPUUTARHA
-  NIITTY
-  NURMIKKO
-  PIENIKOKOINEN PUU, ALLE 10 M
-  ISOKOKOINEN PUU, YLI 10 M
-  VILJELYLAATIKKO



Kaupunginosa Tammela	Kortteli / Tila 344	Tontti 1
Rakennustoimenpide Uudisrakennus	Piirustuslaji Vihersuunnitelma	Suunnitteluala MAS
Rakennuskohde Ki Oy Kullervo Salhojankatu 5 33500 Tampere	Piirustuksen sisältö Luonnossuunnitelma pihasta asemakaavavaiheeseen	Mittakaava 1:200 @A3
 lännenviherpalvelu	Lännen Viherpalvelu Kokkolankatu 4 33300 Tampere (03) 31423400 www.lkpalvelu.fi	Päivämäärä 2.6.2022
		Suunnittelija Elina Santos